



# POOL TIMER MINI

## INSTRUCTION MANUAL

CE

---

STEIEL Elettronica S.r.l. – Viale Europa, 24 – 35020 Ponte San Nicolò – PADOVA - ITALY  
Tel. +39 049.8961488 – [www.steiel.it](http://www.steiel.it) – [info@steiel.it](mailto:info@steiel.it)

---

**Certified Company, according to UNI EN ISO 9001 standards**

---

## WARNINGS



This manual is dedicated to the technical personnel responsible of the installation, management, and maintenance of the plants. The manufacturer assumes no responsibility for damages or malfunctions occurring after intervention by non-authorized personnel, or not compliant with the prescribed instructions.



Before performing any maintenance or repair action, ensure that the system is electrically and hydraulically insulated.



Dispose of waste material and consumables accordingly with local regulations.

## GENERAL SAFETY TIPS



**WARNING!** Before performing any operation on the pump, unplug the pump and discharge the liquid from the pump head and tubes. **Never operate on working pump!**



During maintenance and repair of parts that normally become in contact with chemicals, always wear all prescribed personal protections (gloves, clothes, glasses, etc.). The pump must be handled by qualified personnel only. Always use original spare parts for maintenance.

***Failure to follow instructions can cause damage to the equipment and, in extreme cases, to people.***

## How to ship the equipment

To send back the device for repairing or calibration purposes, proceed as follows:

- Fill the module “REPAIR REQUEST AND DECONTAMINATION DECLARATION” supplied with this manual and include it in the transport documentation.
- Clean the device properly, to eliminate any hazardous residuals.

**The manufacturer can modify the instrument or the technical manual without advanced notice.**

## Warranty

All our products are warranted for a period of 12 months from the delivery date.

Warranty is not valid if all instructions of installation, maintenance, and use, are not strictly followed by the user. Local regulations and applicable standards have also to be followed.

In particular, the warranties regarding the operational safety and reliability of dosing pumps will be recognized only if the following conditions are fulfilled:

- The installation, wiring, adjustment, maintenance, and repairs performed only by qualified personnel.
- The dosing pump was used according to instructions provided in this manual.
- Only original spare parts have been used for repairs.

# TABLE OF CONTENTS

PACKING LIST .....	page 4
TECHNICAL CHARACTERISTICS.....	4
DIGITAL TIMER.....	5
<i>Button Keys</i> .....	5
<i>Technical Data</i> .....	5
<i>Setting the Clock</i> .....	5
<i>Setting the Timer</i> .....	5
PERISTALTIC PUMP .....	6
<i>Technical Data</i> .....	6
<i>Hydraulic Connections</i> .....	6
<i>Maintenance and Storage</i> .....	7

## PACKING LIST

The POOL TIMER MINI is supplied complete with:

- Kit of standard accessories for peristaltic pump, including suction and injection tubes, foot filter and injection valve
- Instruction manual





## TECHNICAL CHARACTERISTICS

Working Temperature	0 to +50 °C
Storage Temperature	-10 to +50 °C
Power Supply	230 V~ (or 115 V~) $\pm 10\%$ , 50/60 Hz; 8 W, 35 mA
Case	shockproof ABS
Dimensions	200 x 150 x 80 mm
Weight	approx. 2 kg
Installation	wall mounting
Protection Rate	IP54
Peristaltic Pump	refer to the dedicated section

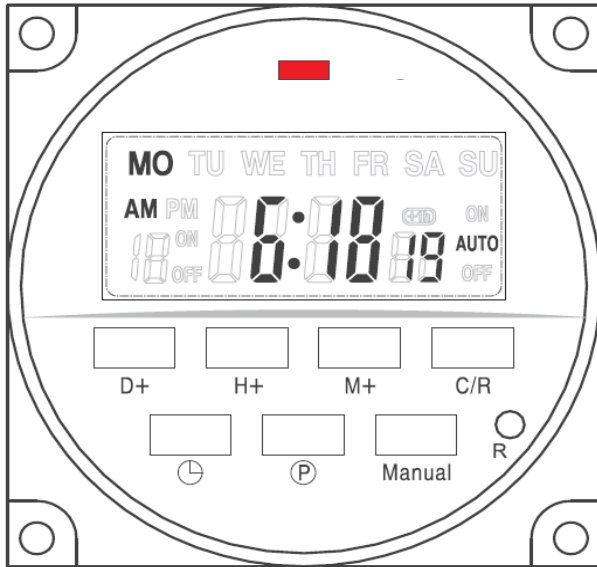
## DIGITAL TIMER



### Button Keys

- Manual mode
-  Timer
-  Clock
- D+ Day of the week
- H+ Hours
- M+ Minutes
- C/R Cancel / Recall

### Technical Data

Timing Range	1 min ... 168 hours
Black-out	90 days
Schedule	up to 16 ON/OFF per day
Average Error	< $\pm 2$ seconds / day
RH max	95 %

### Setting the Clock

1. Press simultaneously the Clock and H+ buttons to set the current hour.
2. Press simultaneously the Clock and M+ buttons to set the current minutes.
3. Press simultaneously the Clock and D+ buttons to set the current day of the week.

**Note:** Hold the Clock button for approx. 3 seconds to shift from 24H to 12H time format

### Setting the Timer

1. Press the P (timer) button to enter timer setting mode; the "1ON" indication is displayed.
2. Press H+ and then M+ to set the first ON time (hours and minutes, respectively).
3. Press D+ to set the day(s) of the first ON; different combination can be chosen, e.g., every day, or groups of days (15 combinations are available; for example: MO.WE.FR / TU.TH.SA / SA.SU / MO.TU.WE.TH.FR / MO.TU.WE.TH.FR.SA 7 etc.).
4. Press the P (timer) button and the "1OFF" indication is displayed.
5. Press H+ and then M+ to set the first OFF time (hours and minutes, respectively).
6. Press D+ to set the day(s) of the first OFF.
7. Repeat step 2 to 6 for setting 2<sup>nd</sup> to 16<sup>th</sup> timer ON/OFF.

# PERISTALTIC PUMP

## Technical Data

Flow Rate	2.4 l/h @ 1 bar
Materials	PP case and fittings, polycarbonate front panel and transparent protection, PBT roller-holder with Delrin (self-lubricant) rollers, Santoprene internal tube
External Tube	4x6 mm

## Hydraulic Connections

**Warning!** Avoid restricting or sharp bends in the suction and injection pipes, as they may affect the performance and durability of the pump itself.

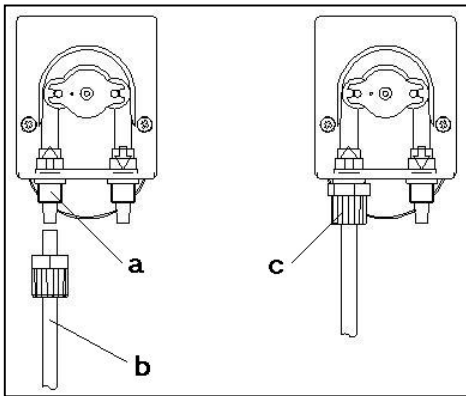

### **Suction line:**

Connect the suction tube (b) to the suction connection (a) and tighten the threaded nut (c).

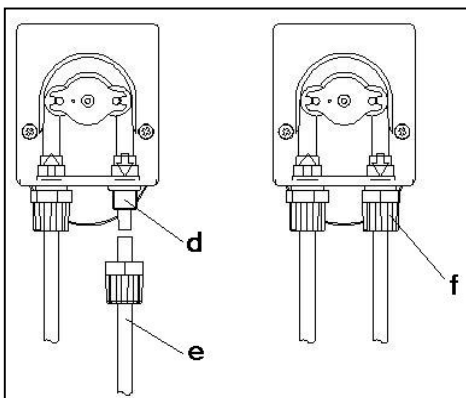

### **Injection line:**

Connect the injection tube (e) to the injection connection (d) and tighten the threaded nut (f).

## **Maintenance and Storage**

The periodic maintenance operations are essential for the proper functioning of the system and its duration in time. The below advice should be strictly followed:

- Check the level of the solution to be dosed to prevent the pump from running dry.
- Check that the suction and delivery pipes are clean and not containing any impurities, which could damage the tube and cause flow rate anomalies.
- Frequently check the pump operation, when dosing aggressive liquids.
- Check that the filter is not clogged to avoid the decreasing of flow rate.

### ***Replacing the peristaltic tube:***

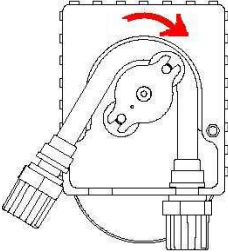
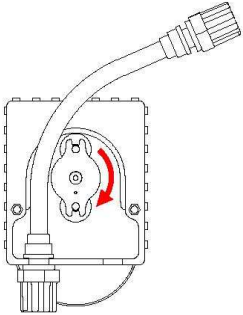
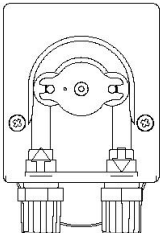
	<p>Unscrew the two front screw and remove the transparent cover. Remove the old tube first unlocking the fitting on the left and turning the roller-holder as indicated by the arrow in the figure, to free the tube to the fitting on the right.</p>
	<p>Insert the left fitting into the new pipe, in its place, ensuring that the rounded side is positioned inwards. Then turn the roller-holder clockwise, so that the tube is inserted in its seat.</p>
	<p>Insert the right fitting in its place and secure the transparent cover by tightening the two front screws.</p>

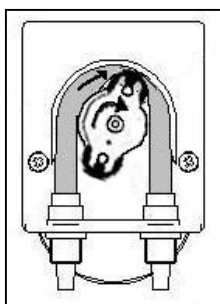

### ***Pump wintering:***

Before shutting down the system for wintering or anyway for a long period, dose clean water to rinse the tube, then rotate the roller-holder clockwise to position it as shown in the figure.